





## Wi SYSTEM DETAILS

The Wi System is a versatile method of replacing traditional windposts and lintels in masonry construction. The Wi System and its constituents incorporate a number of patents, patent applications, community design registrations and trademarks. All rights are reserved © Wembley Innovation Ltd, 2019.

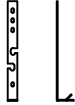

## Wi TROUGH LINTEL COMPONENTS

TRANSFER ROD - SHORT	
16mm Diameter REBAR	

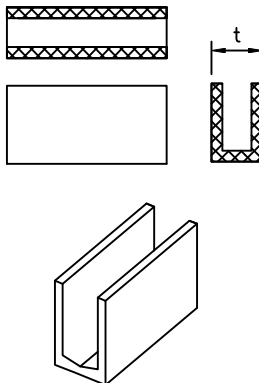
C40 Wi CONCRETE MORTAR AVAILABLE IN SILOS, 1 TON BAGS AND 25kg BAGS FROM CPI (REFER TO USER MANUAL FOR MIXING GUIDANCE)	
Wi TROUGH BLOCK t=100mm, 140mm, 190mm, 215mm	

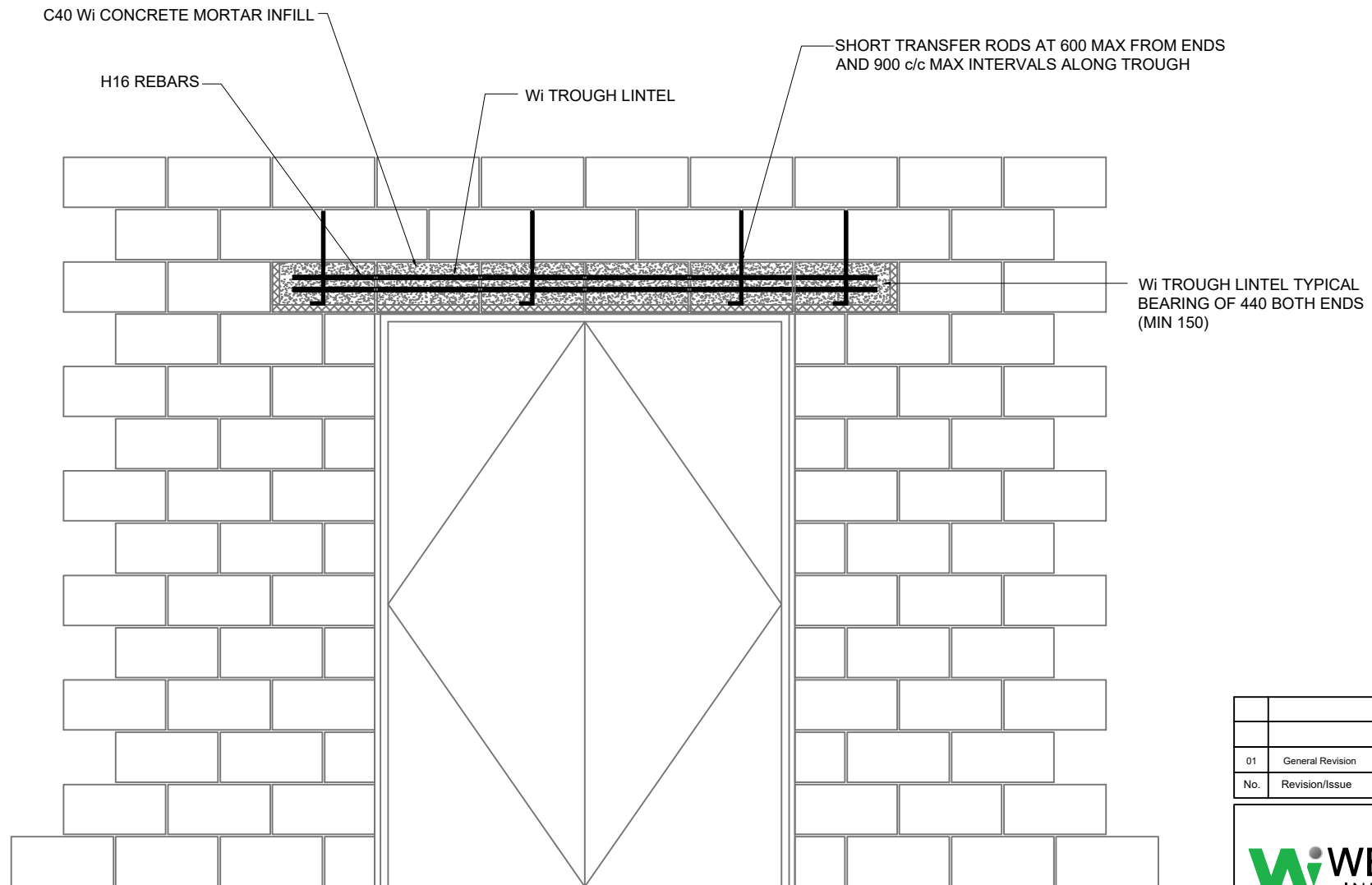

SECTIONAL ELEVATION

01	General Revision	22/02/17
No.	Revision/Issue	Date

**Wi WEMBLEY**  
INNOVATION™

PRINCIPAL Wi DETAILS

DETAIL 14

Wi TROUGH LINTEL TO  
DOOR OPENING

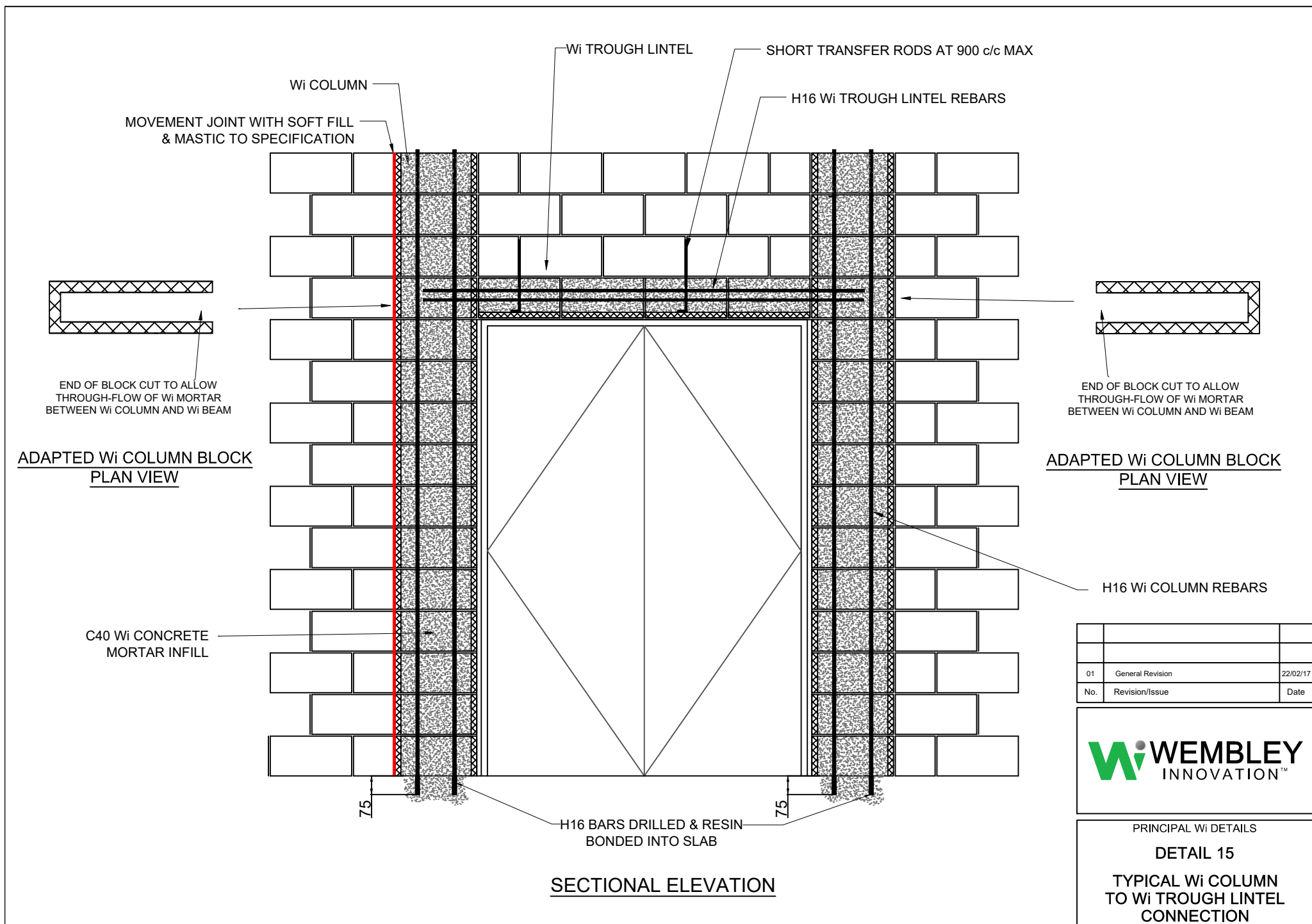



© Wembley Innovation Ltd, 2019

"Wi COLUMN", "SLOT BLOCK", "U-BLOCK", "Wi BEAM" and the "Wi" device mark are registered Community trade marks of Wembley Innovation Limited.

The Wi BEAM / Wi COLUMN building system and its components are the subject of a number of Community design registrations (CDRs),  
patent and patent applications, including:

CDRs 000881263-0001 to 0005, 005810579-0001 to 0004, 002391136-0001 to 0002, 000992136-0001, 001126635;

UK & EU patent Nos. 2440531, 2442543, 2054563, 2313575, 2469272, 2509149, 2935715, 2250323, 2444258, 2485397, 1711069.3;

EU Trademarks 006884936, 006885396, 008355141, 008355166, 008807612;

International patent Nos. 2007280305, 2659536, 575214, 12/309795, 2726735, 2009254997, 2313575, 2013366093, 2892704, 708518, 9523194.